

# Imagine a YMCA in a Kent Park

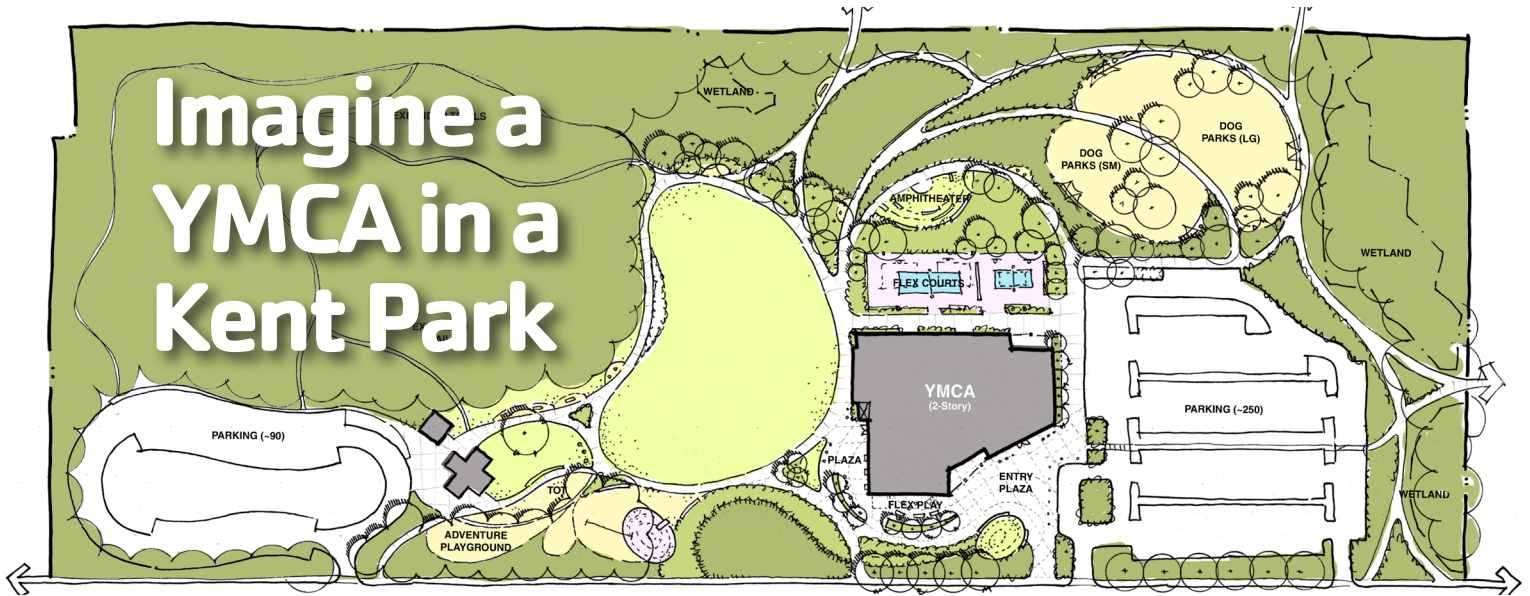

## City of Kent Parks Request: \$3,000,000 Morrill Meadows/East Hill Park Renovation

### Why Morrill Meadows/East Hill Park?

- Convenient location – 80% of Kent's residents live on the East Hill
- Expands health and wellness opportunities for a population with disproportionately high obesity rates
- Completed land assembly – the City acquired the property between the two existing city-owned parks needed to combine them into one

### Project Status – Three Phases

The City is prepared to begin site preparation work in 2017.

- **Phase 1** - Master planning, demolition of dilapidated facilities, frontage and drainage improvements.
- **Phase 2** – YMCA construction in 2018
- **Phase 3** - Construction of the remaining parks improvements.

### Total Cost/Funding Status

- An estimated \$30 million public/private partnership with more than two-thirds coming from private sources
- \$1.53 million – Site acquisition and improvements - City of Kent
- \$485,000 – Site planning and prep - 2015 Washington State Dept. of Commerce Grant

### Bring High Quality Indoor Outdoor Recreation to Kent's Underserved Community

Kent asks lawmakers to support \$3 million in public infrastructure investments to combine and update the Morrill Meadows and East Hill Parks to accommodate Kent's first YMCA.

Kent is Washington's sixth largest city with a population of nearly 125,000, making it by far the largest without a YMCA, a Boys & Girls Club or a YWCA.

This lack of community center space is even more acute considering nearly half of the students in Kent schools utilize free or reduced lunch programs.

### City of Kent and YMCA of Greater Seattle Partners in Park Renovation

The City of Kent and the YMCA are partnering to renovate and combine Morrill Meadows and East Hill Parks to work better as one. The existing spaces, both in dire need of renovation, will be combined and become home to a new YMCA.

This unique public/private partnership will create a vibrant, indoor/outdoor recreation experience for an underserved community. Outdoor amenities will include:

- Sport Court
- Relocated Dog Park
- Playground
- Outdoor Amphitheater
- Connected Trails



**Hope Gibson**  
City of Kent, Parks Planning  
and Development Manager  
253-856-5112  
HGibson@KentWA.gov

**Nathan Phillips**  
YMCA of Greater Seattle,  
Regional Vice President  
206-851-5084  
NPhillips@SeattleYMCA.org